

**Insight**  
Acoustic Glass Moving Walls

[www.creatif.org.uk](http://www.creatif.org.uk)

## 02\_Insight: Acoustic Glass Moving Walls

Insight is a very special kind of moving wall with maximum transparency and optimum acoustics.

The philosophy of precise engineering carries through to the internal mechanisms. Basic panels have extension rods within the frame and the final panel in a run features a telescopic nose in a solid material. Alternatively, an expanding jamb can be specified.

Insight from Creatif is the only glass moving wall system to offer a fully glazed pass door, both inset and full-height. The acoustic performance of Insight is a truly remarkable Rw 45db.

## Contents:

<b>Page 03-04</b>	Gallery
<b>Page 05</b>	Technical Details
<b>Page 06</b>	Standard Stacking Configuration
<b>Page 07</b>	Technical Informations
<b>Page 08</b>	Finishes
<b>Page 09</b>	Panels Elevations
<b>Page 10</b>	MFC Colours
<b>Page 11</b>	Writable Surfaces
<b>Page 12</b>	Antibacterial Surfaces
<b>Page 13</b>	Contact







# 05\_Technical Details

- 1. Standard Panel
- 2. Fixed Jamb
- 3. Twin Point
- 4. Single Point
- 5. Floor Seal
- 6. TP with Pelmet
- 7. SP with Pelmet

Contact Creatif for info on closing elements: [sales@creatif.org.uk](mailto:sales@creatif.org.uk)

1

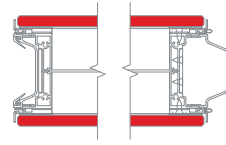

2



3

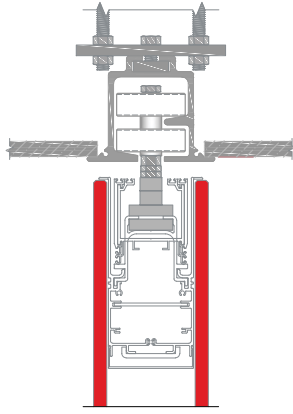

4

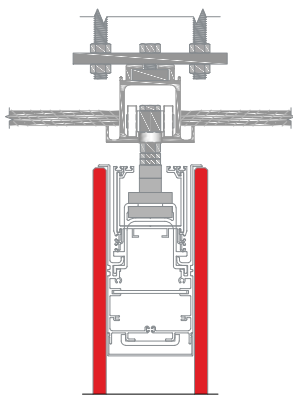

5

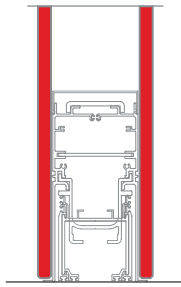

6

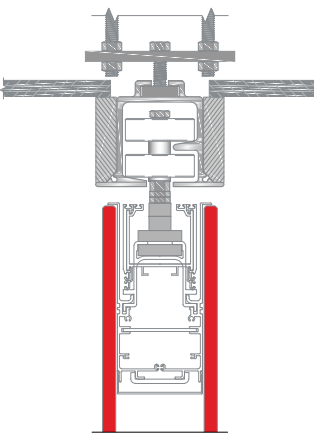

7

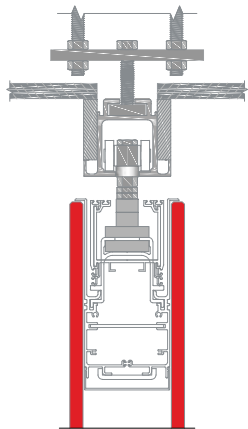

## 06\_Standard Stacking Configurations

Config A  
**Single-point**

Config B  
**Twin-point, H-park**

Config C  
**Twin-point, Offset Stack**

Config D  
**Twin-point, Linear Stack**

Config E  
**Twin-point, H-park Split**

Config F  
**Twin-point, Split Offset Track**

**Please note:**  
Panel thickness will vary depending on system type.  
Other stacking options are available on request.

A

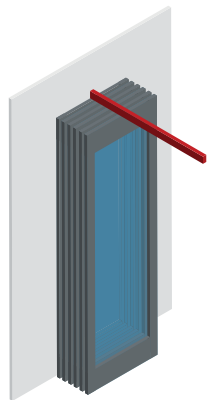

B

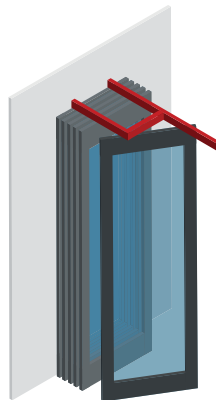

C

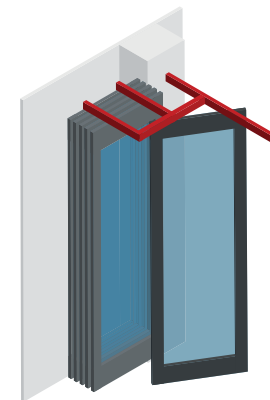

D

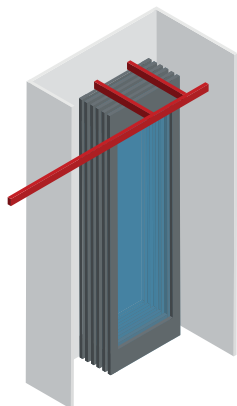

E

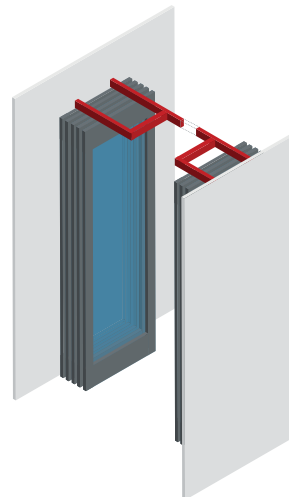

F

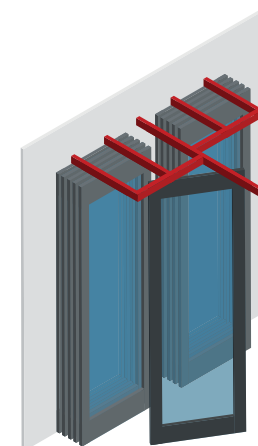

## 07\_Technical Information

Insight features superb engineering. Each panel is formed from a 90mm aluminum frame overclad either side with 6mm toughened glass. The frame is concealed by an ultra-thin frit on the inside face in any RAL colour.

	INSIGHT
Acoustic ratings dB (Rw)	53 dB
Panel thickness	110mm
Weight KG/M2	Contact Creatif for details
Max. height	3500mm
Max. panel width	1250mm
Board type	SAA Aluminum Profiles + Glass
Operable seal	Semi-automatic (button operated)
Track system	Aluminum SP+ TP
Tolerance height MM	+/-3mm
Tolerance width MM	+/-3mm

## 08\_Finishes

Other colours available on request. Contact Creatif:

[sales@creatif.org.uk](mailto:sales@creatif.org.uk)



Back-painted glass



Manifestations

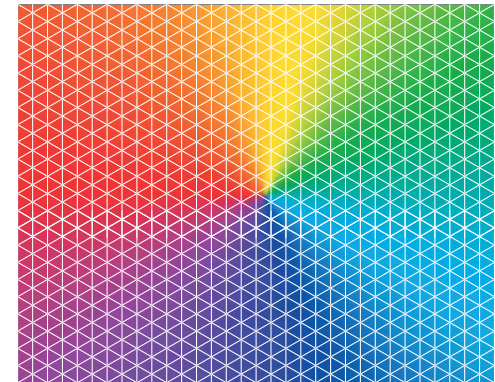

Powder-coated RAL colours for profiles and tracks  
Other colours available on request

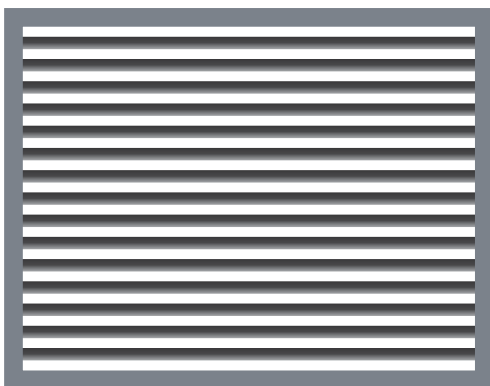

Internal Blinds

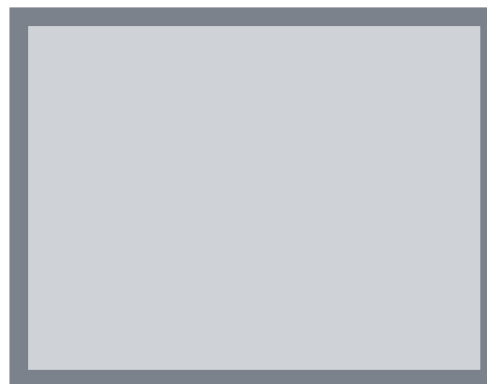

Switch Privacy Glass



## 09\_Panel Elevations

For constraints and variations contact Creatif:  
[sales@creatif.org.uk](mailto:sales@creatif.org.uk)

Ironmongery and Vision panels subject to constraints, contact us for Information

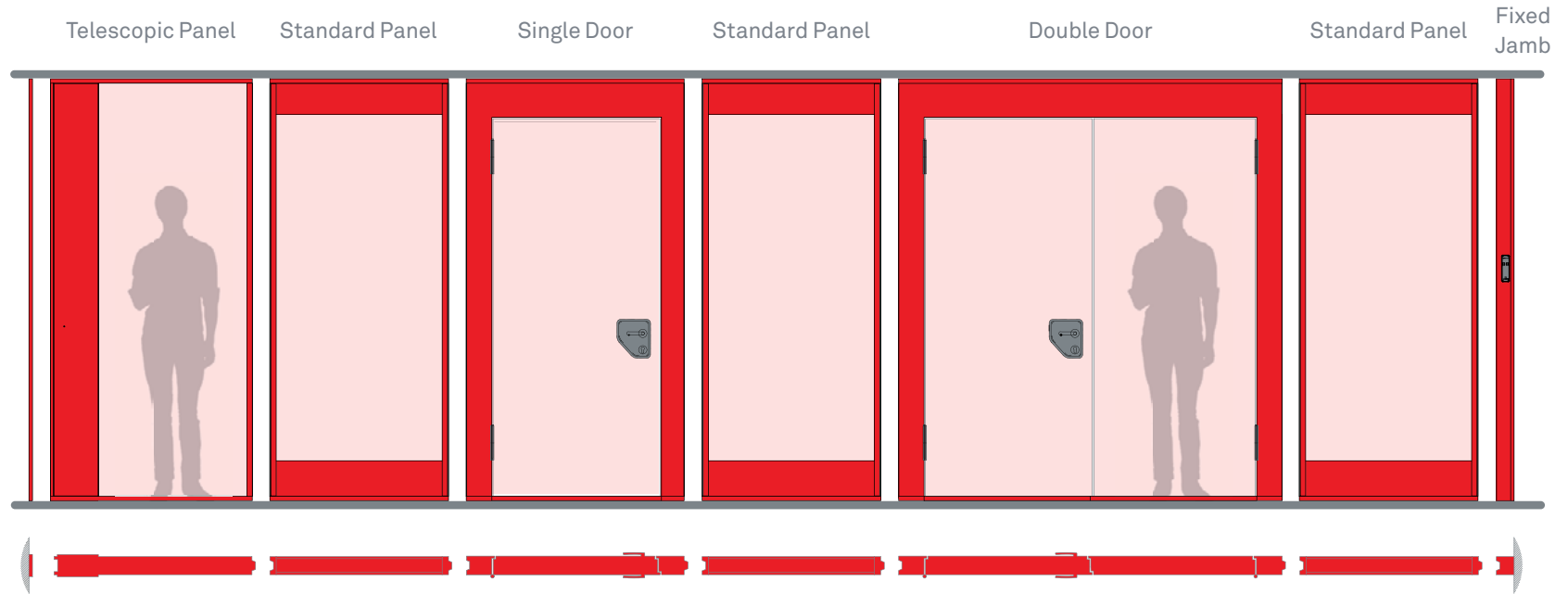

## 10\_MFC Colours

Tough, long-lasting melamine faced chipboard available in a range of high quality finishes to suit any interior.

Our cost-effective, high-quality MFC boards come in a variety of colours.

Please contact us for a sample.



Tobacco Aida Walnut  
H3704 - Egger



UniPaint  
PG - Unilin



Light Sorano Oak  
H1334 - Egger



Verona Cherry  
H1615 - Egger

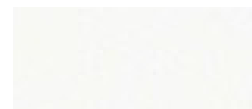

Premium White  
W1000 - Egger



Black  
U999 - Egger



Grey Nebraska Oak  
H3332 - Egger

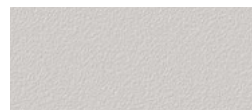

Light Grey  
U708 - Egger



Winchester Oak  
H1381 - Egger



Shorewood  
H3090 - Egger



Light Atelier  
4298 - Kronospan



Mainau Birch  
H1733 - Egger

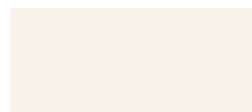

Porcelain White  
W1200 - Egger



Lugano Oak  
0687 - Kronospan



White  
0101 - Kronospan



Maple  
0375 - Kronospan



Lancaster Oak  
H3368 - Egger



Mangfall Beech  
1783 - Kronospan

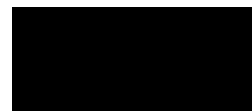

Black  
0190 - Kronospan



Walnut Opera  
0481 - Kronospan



English Oak  
H1310 - Egger



Bavarian Beech  
H1511 - Egger



Maple  
H1521 - Egger

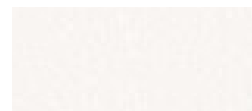

Platinum White  
W980 - Egger



White  
020 - Unilin



Bavaria Beech  
0381 - Kronospan

## 11\_Writable Surfaces

Functional, flexible workspaces that are designed for collaborative and agile working benefit greatly from extra writing surfaces for those all important meetings and brain-storming sessions.

With our writable finishes, you can literally write all over our Insight walls.

Our Drywipe and Back-painted glass finishes also come with optional handy magnetic capabilities built in.

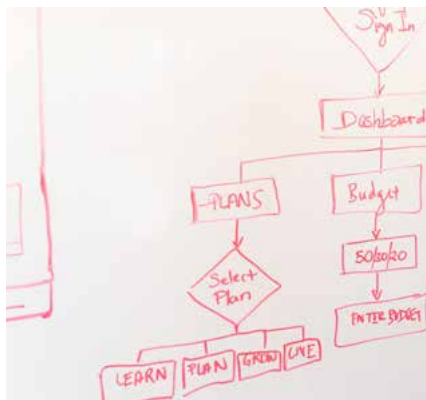

Drywipe



Chalk board

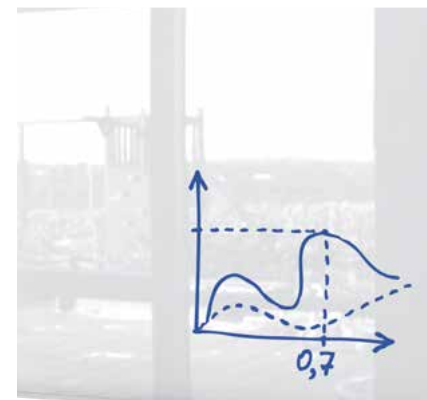

Back-painted glass

## 12\_Antibacterial Surfaces

Courtesy of Egger's PerfectSense range of lacquered boards, our Insight moving walls can be optimised for the post-pandemic workspace, with antibacterial surface property in accordance with ISO 22196.

The PerfectSense range of finishes is available as a gloss option with a deep, reflective, glass-like surface, or a matt option which is warm and smooth to the touch, with high resistance and anti-fingerprint properties.

### Matt Colours



Dust Grey  
U732 PM - Egger



Premium White  
W1000 PM - Egger



Black Pietra Grigia  
F206 PM - Egger



Graphite Grey  
U961 PM - Egger



Stone Grey  
U727 PM - Egger

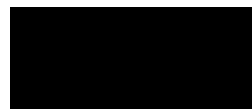

Black  
U999 PM - Egger



Indigo Blue  
U599 PM - Egger



Alpine White  
W1100 PM - Egger



Cashmere Grey  
U702 PM - Egger



Light Grey  
U709 PM - Egger



White Levanto Marble  
F812 PM - Egger



Dark Steel  
F627 PM - Egger



Light Grey Metal Rock  
F120 PM - Egger

### Gloss Colours



Graphite Grey  
U961 PG - Egger



Alpine White  
W1100 PG - Egger

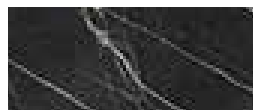

Black Pietra Grigia  
F206 PG - Egger



Light Grey  
U709 PG - Egger



White Levanto Marble  
F812 PG - Egger



Black  
U999 PG - Egger



Premium White  
W1000 PG - Egger



Cashmere Grey  
U702 PG - Egger



Red Chilli  
U232 PG - Egger



Dust Grey  
U732 PG - Egger



Stone Grey  
U727 PG - Egger

## 13\_Contact

### Details

T: +44 (0) 113 270 1239

F: +44 (0) 113 239 1672

E: info@creatif.org.uk

### Head Office

Unit 2 National Road  
Business Park,  
National Road,  
Leeds LS10 1TE

Visit our website to find out more...



[www.creatif.org.uk](http://www.creatif.org.uk)